

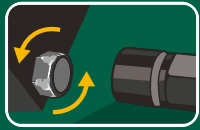

Choose your BoltBiter Set

The BoltBiter sets come with a durable blow mold case for storage and organization. Sets include a 3/8" drive ratchet with quick release design for rapid socket removal. The ratchet flush mounted reversing lever allows user to change direction with one hand without removing the wrench.



Bi-directional design removes or tightens damaged fasteners

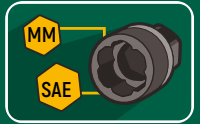

Dual sized sockets work with both SAE and metric fasteners



Removes rusted and rounded fasteners



Black oxide finish to resist corrosion



DISCOVER MORE

23 Pc. 1/4" and 3/8" BoltBiter Set

Article Code	Contents
ST09138	1 - 3/8" Drive Quick-Release Ratchet 4 - 1/4" Extraction Sockets -7 mm, 7 mm, -8 mm, 8 mm 16- 3/8" Extraction Sockets -10 mm, 10 mm, -11 mm, 11 mm, -12 mm, 12 mm, -13 mm, 13 mm, -14 mm, 14 mm, -16 mm, 16 mm, -17 mm, 17 mm, -19 mm, 19 mm 1 - 3/8" Drive Wobble Extension Bar 6" 1 - 3/8" Drive Adapter 3/8"FX1/4"M

13 Pc. 1/4" and 3/8" BoltBiter Set

Article Code	Contents
ST09137	1 - 3/8" Drive Quick-Release Ratchet 2 - 1/4" Extraction Sockets 7 mm, 8 mm 8 - 3/8" Extraction Sockets 10 mm, 11 mm, 12 mm, 13 mm, 14 mm, 16 mm, 17 mm, 19 mm 1 - 3/8" Drive Wobble Extension Bar 6" 1 - 3/8" Drive Adapter 3/8"FX1/4"M



Single BoltBiter Extraction Sockets

Article Code	Description	Article Code	Description
SC12801	1/4" / -7 mm	SC12814	3/8" / -13 mm
SC12802	1/4" / 7 mm	SC12815	3/8" / 13 mm
SC12803	1/4" / -8 mm	SC12816	3/8" / -14 mm
SC12804	1/4" / 8 mm	SC12817	3/8" / 14 mm
SC12807	3/8" / -10 mm	SC12820	3/8" / -16 mm
SC12808	3/8" / 10 mm	SC12821	3/8" / 16 mm
SC12809	3/8" / -11 mm	SC12822	3/8" / -17 mm
SC12810	3/8" / 11 mm	SC12823	3/8" / 17 mm
SC12811	3/8" / -12 mm	SC12826	3/8" / -19 mm
SC12812	3/8" / 12 mm	SC12827	3/8" / 19 mm

