



Redefining Fastener Extraction



SATA

**MADE TO
CHALLENGE**



BOLT BITER

Firmly Grips any Rusted or Rounded Fastener

Struggling with a rusted, rounded or stripped screw head? SATA BoltBiter fastener extraction tools are the solution. SATA BoltBiter makes your life easier by redefining fastener extraction - reliably removing stubborn nuts and bolts. Unique fastener gripping technology extends the lifespan of the sockets compared to traditional fastener cutters.

BoltBiter - the innovative extraction socket system from SATA!



Minus-sized sockets (A) designed to fit extremely worn-down fasteners
Sockets Marked "A": minus-sized
Sockets Marked "B": standard-sized

High-visibility laser-etched markings for quick size identification



Chrome molybdenum alloy steel (Cr-Mo) for exceptional strength and durability

Hexagonal base for use with impact guns, ratchets, wrenches or pliers



Innovative tapered flutes for easy seating onto a damaged fastener

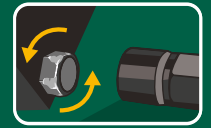

Bi-directional design removes or tightens damaged fasteners

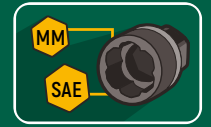

Dual sized sockets work with both SAE and metric fasteners



Removes rusted and rounded fasteners



Black oxide finish to resist corrosion

Durability and Fastener Re-Use

The bi-directional design means the BoltBiter can tighten any fastener just as easily as it can remove it. The ability to re-use a damaged fastener makes the BoltBiter the perfect tool for specialized components. Innovative tapered flute openings allow the socket to easily connect with the fastener, eliminating the need for a striking tool and reducing jamming in the socket compared to traditional extraction. Minus-sized sockets fit a wide range of damaged fasteners.



DISCOVER MORE



Choose your BoltBiter Set

The BoltBiter sets come with a durable blow mold case for storage and organization. Sets include a 3/8" drive ratchet with quick release design for rapid socket removal. The ratchet flush mounted reversing lever allows user to change direction with one hand without removing the wrench.

23 Pc. 1/4" and 3/8" BoltBiter Set

Article Code	Contents
ST09138	1 - 3/8" Drive Quick-Release Ratchet 4 - 1/4" Extraction Sockets -7 mm, 7 mm, -8 mm, 8 mm 16 - 3/8" Extraction Sockets -10 mm, 10 mm, -11 mm, 11 mm, -12 mm, 12 mm, -13 mm, 13 mm, -14 mm, 14 mm, -16 mm, 16 mm, -17 mm, 17 mm, -19 mm, 19 mm 1 - 3/8" Drive Wobble Extension Bar 6" 1 - 3/8" Drive Adapter 3/8"FX1/4"M

13 Pc. 1/4" and 3/8" BoltBiter Set

Article Code	Contents
ST09137	1 - 3/8" Drive Quick-Release Ratchet 2 - 1/4" Extraction Sockets 7 mm, 8 mm 8 - 3/8" Extraction Sockets 10 mm, 11 mm, 12 mm, 13 mm, 14 mm, 16 mm, 17 mm, 19 mm 1 - 3/8" Drive Wobble Extension Bar 6" 1 - 3/8" Drive Adapter 3/8"FX1/4"M



Single BoltBiter Extraction Sockets

Article Code	Description
SC12801	1/4" / -7 mm
SC12802	1/4" / 7 mm
SC12803	1/4" / -8 mm
SC12804	1/4" / 8 mm
SC12807	3/8" / -10 mm
SC12808	3/8" / 10 mm
SC12809	3/8" / -11 mm

Article Code	Description
SC12810	3/8" / 11 mm
SC12811	3/8" / -12 mm
SC12812	3/8" / 12 mm
SC12814	3/8" / -13 mm
SC12815	3/8" / 13 mm
SC12816	3/8" / -14 mm
SC12817	3/8" / 14 mm

Article Code	Description
SC12820	3/8" / -16 mm
SC12821	3/8" / 16 mm
SC12822	3/8" / -17 mm
SC12823	3/8" / 17 mm
SC12826	3/8" / -19 mm
SC12827	3/8" / 19 mm



Authorized Distributor

Apex Tool Group B.V.
 Phileas Foggstraat 16
 7821 AK Emmen
 The Netherlands
 T. +31 (0) 591 667 504
www.satatools.eu

Disclaimer

Specifications subject to change without notice.
 SATA is a registered trademark of Apex Brands, Inc. | © 2022
 HT1080 100ST / 02.22 BO 2.5